

All Dimensions Are  
In mm Unless Stated.

Chamfered Beading Profile - See DP15822

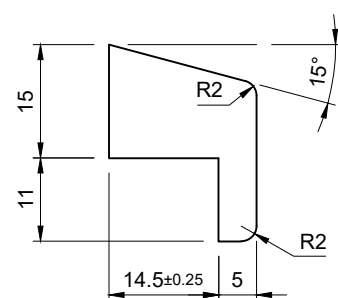

#### Notes:-

Only Employees With A Signed Training Record For This Glazing System To Use This Glazing System

Glazing MUST Be To This Drawing - Do NOT Mix Glazing Systems Even If They Appear The Same

Quality Standard Of The Glazed Aperture To Work  
Instruction WI-021

Material Specification For Glass - MS\_006

Material Specification For Beading - MS\_007

Aperture 17mm Larger Than Glass

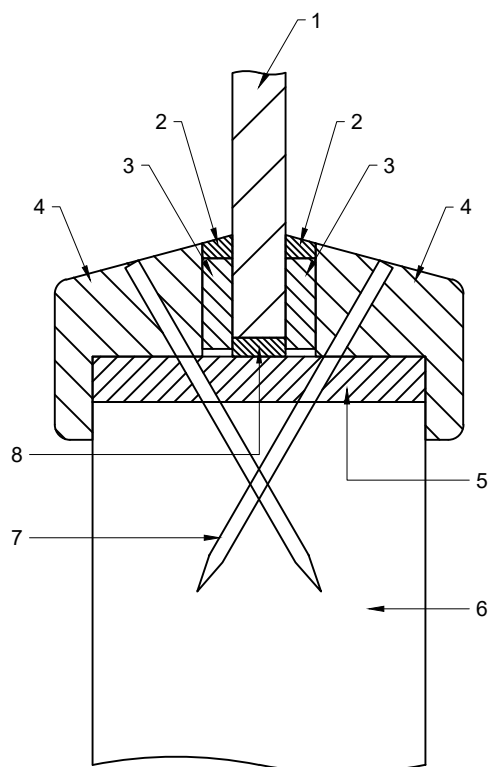

#### Key:-

1. Pyrobelite 7
2. Neutral Silicone Capping
3. 12mm Wide x 5mm Sealmaster Black Closed Cell Foam Tape
4. 26mm High x 19.5mm W (Including 5 x 5mm Minimum Bolection With 15° Chamfer Or Square) Hardwood Glazing Bead, Minimum Density 640kg/m³. See Drawing DP15822
5. 6mm Thick Hardwood Aperture Liner
6. Nominal 44mm Thick FD30 Door Leaf
7. 50mm Long Steel Pins At A Maximum Of 150mm Centres, 30° To The Vertical & A Nominal 50mm From Each Corner
8. Hardwood Or Non-Combustible Glazing Setting Block

Do Not Scale.

If In Doubt Ask!

Description: 7mm Pyrobelite Glazing System - Chamfered Bolection Bead

© Doorpac Limited

Size: See Above

Drawing No: DP15828



Unit 6, Ranskill Court  
Sheffield,  
S9 5FZ.

Tolerance: +/- 0.5mm

Drawn By: P. Brash

Approved: M. Jenkinson

Revision: 01

Drawn Date: 07/12/2022

Machining: